

4

3

2

NOTES:

- 1 BERYLLIUM ENTRANCE WINDOW
.010 [0,254] THK.
(BARE METAL FINISH)
- 2 NAI(TL) CRYSTAL
Ø1.000 [25,4] X .040 [1,016] THK.
- 3 ALUMINUM CRYSTAL HOUSING
(CLEAR ANODIZED FINISH)
- 4 QUARTZ GLASS OPTICAL WINDOW
.062 [1,57] THK.
- 5. PERFORMANCE SPECIFICATION:
PHR: 55% OR BETTER FOR Fe-55

REVISIONS				
ZONE	REV.	DESCRIPTION	DATE	APPROVED
C-4	B	QUARTZ WAS K+	6/22/05	IND. #1280

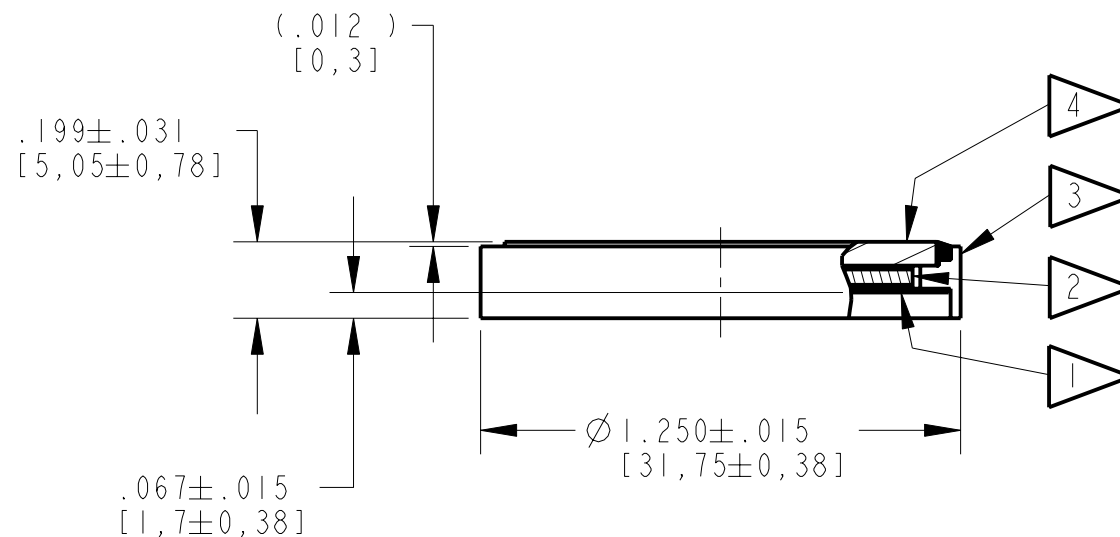
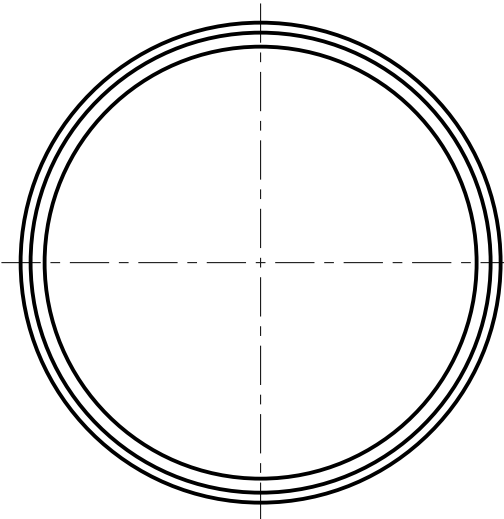

SECTION B-B

<p>CUSTOMER APPROVAL</p> <input type="checkbox"/> APPROVED <input type="checkbox"/> APPROVED AS NOTED <input type="checkbox"/> REVISED & RESUBMIT CUST. INIT. _____ DATE _____	<p>ENGINEERING SALES DRAWING</p> <p>DO NOT SCALE THIS DRAWING THIS DWG IS IN ACCORDANCE WITH ASME Y-14.5M</p>		 12345 Kinsman Rd. Newbury, OH 44065			
	DRAWN: JW 26-May-77		TITLE: MODEL: IXR.040B			
	THIS DOCUMENT IS APPROVED AND MAINTAINED UNDER ELECTRONIC CONFIGURATION CONTROL		SIZE: B	CAGE CODE:	DWG. NO.: SA-05705	REV.: C
<p>THIS PRINT IS THE EXCLUSIVE PROPERTY OF SAINT-GOBAIN CRYSTALS & DETECTORS, A SUBSIDIARY OF SAINT-GOBAIN CERAMICS & PLASTICS, INC. AND IS NOT TO BE FURTHER REPRODUCED OR DISCLOSED TO ANOTHER PARTY WITHOUT PRIOR WRITTEN PERMISSION FROM SAINT-GOBAIN CRYSTALS. COPYRIGHT RESERVED, SAINT-GOBAIN CERAMICS & PLASTICS, INC. 2004</p>		SCALE: 2:1	WEIGHT:	CALC.: <input type="checkbox"/>	ACT.: <input type="checkbox"/>	SHEET: 1 OF 1

4

3

2

1